

The Vision, Strategy, and Target

Vision: We seek to help people follow Christ, wherever they are - wherever they are in geography, income, or life-stage, we want to them to know the “surpassing worth” of knowing and following Jesus.

Strategy: We desire to stir people’s hearts for Jesus, shape them into Jesus’ image, support them as they walk with Jesus, and send them to serve and save like Jesus.

Target: From our new location, we intend to continue our urban ministries in the city, nurture and grow our foreign world missions, and utilize existing and new ministries to reach into the Mid-South and the Houston Levee Neighborhood.

The New Nine: Ministry Possibilities at HL

The Psalm 139 Project: We desire to help people experience God everywhere they go during the week. Strategies might include classes that equip people to overcome spiritual barriers between them and God; prayer events held during the week; special worship gatherings beyond Sunday mornings; and workshops to equip people in spiritual disciplines.

Magnetic Worship: We believe the following qualities will increase the “magnetism” of Highland’s contemporary worship: Diverse, Experiential, Simple, Transparent, Challenging, God-focused, Relational.

Volunteer Central: We desire to better equip each person at Highland to know and use their talents during the week. Strategies include workshops and mentoring to enable each person at Highland to use his/her spiritual gifts and better be Jesus in the community.

Highland Hospitality: From the moment guests arrive on our new property, we want to create a warm and welcoming experience. Strategies include expansion and improvements to our existing greeting ministry and welcome center as well as new initiatives.

Act Like Men 2.0: We desire to build on the growing work of God in the Act Like Men ministry by starting a grassroots movement of men gathering around the city to empower one another to bring God into their workplace.

Highland Community Center: It is critical to use our new property and facility not simply for ourselves but for the larger community. We could intentionally invite area organizations to use our facilities for their functions, offer babysitting at our building for neighborhood families, or enhance our MOVEment Ministry and invite Houston Levee neighbors to join our MOVEment sports activities.

Roof Shouts: We want to do more “roof shouting”, to more loudly communicate to the community about what God is doing through Highland for their sake. Specifically, we want to identify at least three Highland events each year to market significantly to the community with newspaper ads, signs in member’s yards, mail-outs, invitations, and radio spots.

Highland Mother’s Day Out/ Preschool: We want to be a means by which little children in the community come to Jesus. Thus we propose offering a quality state-approved program that will be attractive to families with young children. We would begin marketing the MDO/Preschool in August 2009. We might also consider hosting a Homeschool Chapter and having the Clothing Sale at our facility.

Adopt a School: Just as we have done with LaRose Elementary in Downtown Memphis, we wish to find a school in the Houston Levee area to “adopt” and find ways to serve the staff and students of the school.



The Facility: A Means for Achieving the Mission

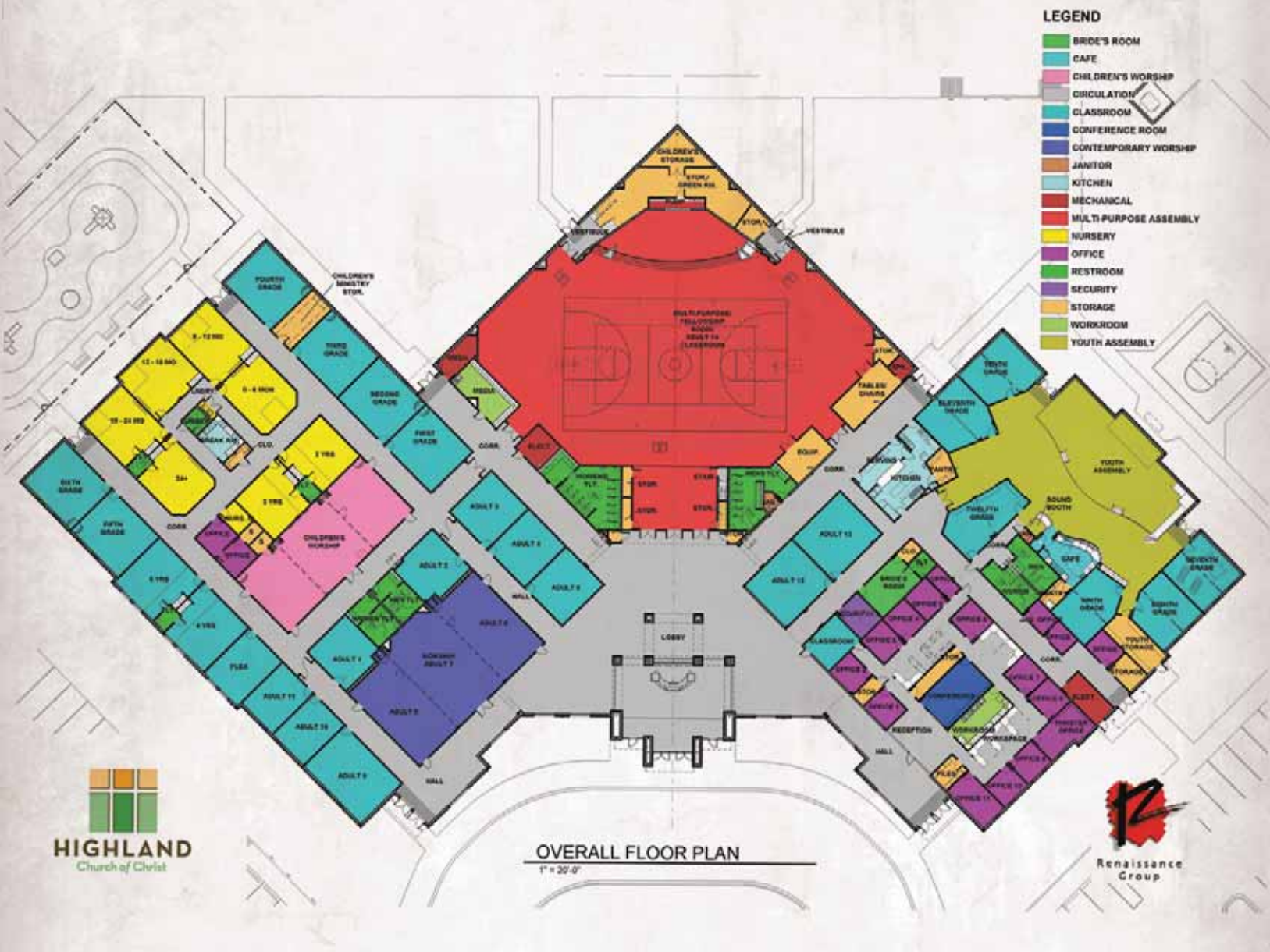

The Investment: Our Gift for Accomplishing the Mission

We give thanks for the \$2,365,302 already given to Ask and Imagine.

A challenge, however, is that in order to fully fund the weekly ministry in the way we believe necessary, we need to raise our weekly giving to \$30,900.

This amount of \$30,900 will also enable us to pay the estimated interest-only debt service for 12-15 months after construction is complete.

The Charge

Because of the current economic struggles in our country, we want to provide those who need it an opportunity to **extend the deadline for meeting your Ask and Imagine pledge by one year**. This would give you four years rather than three to fulfill your pledge.

In addition, for those nearing the fulfillment of a pledge, we want to urge you to **continue giving to Ask and Imagine for an additional year** (increasing your total pledge by 1/3). These additional funds are needed to protect ministry budgets from being impacted by the costs of relocation.